

High power Collimated Output Isolator

Features:

Low Insertion Loss High Isolation & Return Loss
High reliability

Application:

Fiber Laser & Amplifier

Specification

Parameters	Value
Center Wavelength (λ_c) (nm)	1064
Operating Wavelength Range(nm)	± 10
Peak Isolation (dB)	30~35dB
Isolation at 23°C (dB)	≥ 25 dB
Insertion Loss (dB)	< 0.5
Transmission(%)	≥ 90
Return Loss (dB)	≥ 50
PDL (dB)	< 0.15
M2 Degradation	$< 10\%$
Fiber Type	10/125SCF 20/130DC,25/250,30/250
Nominal Output Beam Diameter (mm)	0.3, 0.5, 6mm or Specify
Beam Ellipticity	$> 90\%$
Divergence(Full)	0.5mrad(Full Angle)
Average power Optical Power	20W,50W,100W@10KW
Damage Threshold(10ns, 10hz)	10J/cm ² @1064
Operating Temperature(°C)	10 to +50
Storage Temperature(°C)	-20 to +75

Package dimension:

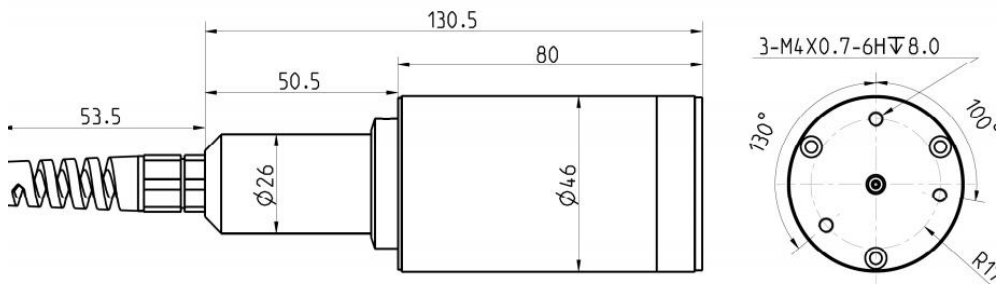

Ordering Information

HPCIS	Wavelength	Beam	Power	Fiber Type	Pigtail Type	Length
	1064=1064	H=0.5mm 6=6mm m	10=10W 20=20W 30=30W 50=50W S=specify	1=10/125 SCF 2=20/130 DCF 3=25/250 DCF	6=6mm Armord tube	H=0.5m 7=0.7m 1=1.0m S=Specify